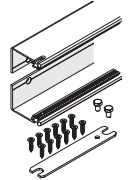
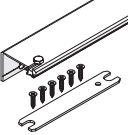
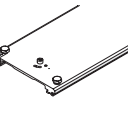
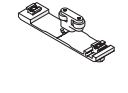

## Connecting profile to the external side or cabinet body

		mm/inch	code
	Connector 55 mm ( $2\frac{3}{16}$ " ) for one pivot/slide-in door, alu plain anodized, 2 pieces	650 ( $2'1\frac{19}{32}$ " )	25438
	Connector 55 mm ( $2\frac{3}{16}$ " ) for one pivot/slide-in door, alu plain anodized, 1 piece	650 ( $2'1\frac{19}{32}$ " )	23221
		900 ( $2'11\frac{7}{16}$ " )	23222

## Connecting profile to the cabinet body

		mm/inch	code
	Connector 110 mm ( $4\frac{11}{32}$ " ) for two pivot/slide-in doors, alu plain anodized, 1 piece	650 ( $2'1\frac{19}{32}$ " )	23223
		900 ( $2'11\frac{7}{16}$ " )	23224
	Connector 110 mm ( $4\frac{11}{32}$ " ) for two pivot/slide-in doors, alu plain anodized, 1 piece (for installation in front of a fixed base)	26 ( $1\frac{1}{32}$ " )	23225

### Connector 55 mm ( $2\frac{3}{16}$ " )

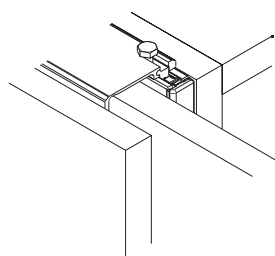

Connector 55 mm ( $2\frac{3}{16}$ " ):  
recess for one pivot/slide-in door

### Connector 110 mm ( $4\frac{11}{32}$ " )

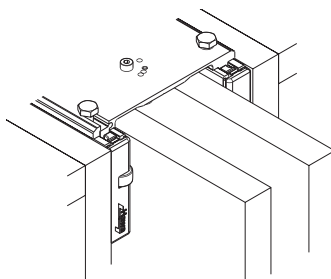

Connector 110 mm ( $4\frac{11}{32}$ " ):  
recess for two pivot/slide-in doors

## Connector for HAWA-Concepta 25/30/40/50

The Connector connection profile for the HAWA-Concepta 25/30/40/50 is a well-thought-out method of simplifying the assembly of designs with pivot/slide-in doors striking against the top and bottom cabinet sections. Assembly is not only easy but also quick and convenient: the cabinet side or body sections are placed adjacent to one another; the Connector connection profile is then inserted in the top tracks and bottom guide channels and screwed tight from above – job done.

### Features of Connector 55 mm ( $2\frac{3}{16}$ " )

- For recesses with a pivot/slide-in door made of wood: 19–30 mm ( $\frac{3}{4}$ "– $1\frac{3}{16}$ " )
- The Connector compensates external side or cabinet body height differences of up to  $\pm 1.5$  mm ( $1\frac{1}{16}$ " )

### Typisch Connector 110 mm ( $4\frac{11}{32}$ " )

- For recesses with two pivot/slide-in doors made of wood: 19–28 mm ( $\frac{3}{4}$ "– $1\frac{1}{8}$ " )
- The Connector compensates cabinet body height differences of up to  $\pm 1.5$  mm ( $1\frac{1}{16}$ " )

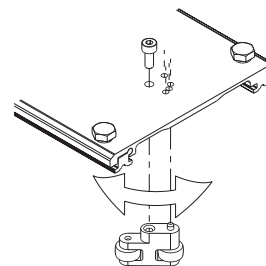

## Kitchen designs with and without a fixed base

The Connector for the HAWA-Concepta 25/30/40/50 is suitable for various kitchen designs. The same connector profile can be used for the top and bottom on designs with adjustable feet. A short 26 mm ( $1\frac{1}{32}$ " ) profile is available for designs with a fixed base.

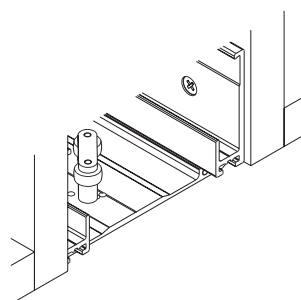

Design with adjustable feet  
Top/bottom profile: No. 23223/23224

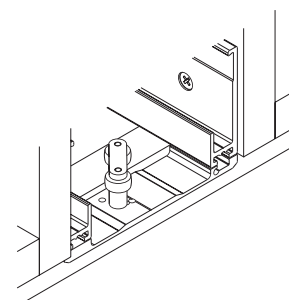

Design with a fixed base  
Top profile: No. 23223/23224  
Bottom profile: No. 23225