

Nexis Click-on 05/90/4

95° blind corner hinge, inset.

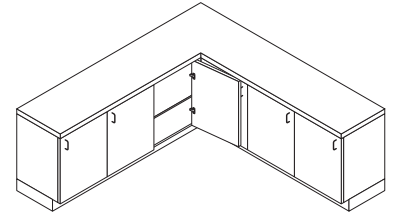

- For direct mounting on protruding post
- Opening angle 95°
- Optimum gap requirements up to door thickness of 30 mm
- Soft-close compatible
- Self-closing
- 3-dimensional adjustment with suitable mounting plate



Inset

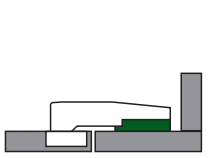

Cup hinge: steel, nickel-plated
Hinge arm: Zamak, nickel-plated

Drilling pattern	Item No.	Item No.
48/9	146.405.53.9615	146.405.54.9615
42/11	138.405.73.9615	138.405.74.9615
	PU 125 pieces	PU 125 pieces

Cover caps	Item No.
*	Steel, nickel-plated, without imprint, Soft-close compatible 514.300.21.0215
**	Black plastic, without imprint, Soft-close compatible 514.000.22.9762
	PU 1000 pieces

* ** on request with individual company logo
* ** on request with Grass imprint
* on request with Grass embossed

PU = packaging unit

Soft-close Click-on	Page 5.8	Click-on mounting plates	Page 2.62 - 2.71	Assembly aids	Chapter 10
Tipmatic Click-on	Page 6.8			Technical Information	Page 2.74 - 2.77

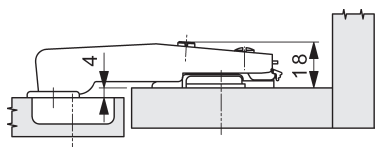

Drawing with mounting plate, height 00

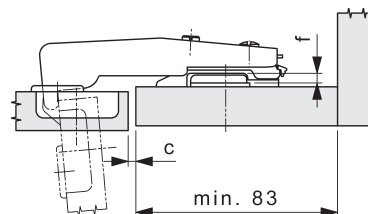

Nexis
Impresso

Nexis
Click-on

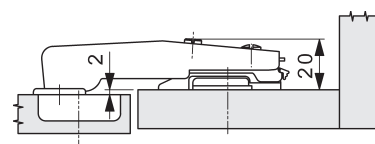

Drawing with mounting plate, height 02

Nexis
Slide-on

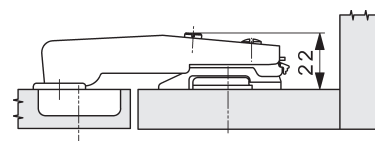

Drawing with mounting plate, height 04

Snap On
3000

Soft-close

Tipmatic

We recommend a trial fitting.

Reveal table

Note

Reveal dimensions were determined with an edge radius (of the door) of 1 mm!

Hinge dimensions and calculation of reveal with factory setting.

We recommend a trial fitting.

Cup distance

	3	4	5	6			
16	0.1	0.1	0.1	0.1			
18	0.2	0.2	0.2	0.2			
19	0.3	0.3	0.3	0.3			
20	0.4	0.4	0.4	0.4			
22	0.7	0.7	0.7	0.7			
24	1.0	1.0	1.0	1.0			
26	1.4	1.4	1.4	1.4			
28	1.9	1.9	1.9	1.9			
30	3.8	2.9	2.6	2.5			
							Reveal min. (c)

illuxo

Special
hinges

Cabinet
accessories

Drilling patterns for screw-fixing version

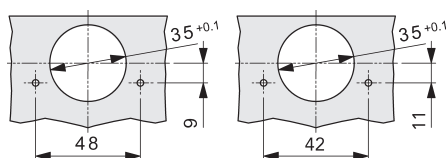

Drilling patterns for press-fitting version

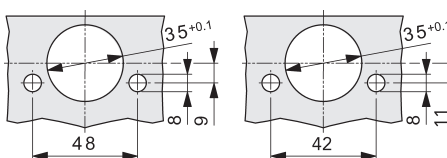

Cup dimensions

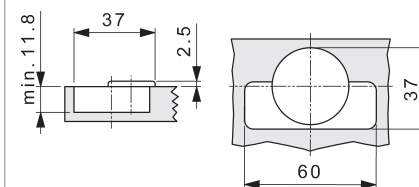

All dimensions in millimetres.

Assembly
aids

Index