

**SIMPLY R1**



Touchless switch

<b>Code</b>	0834901
<b>Input</b>	220-240Vac
<b>Output</b>	220-240Vac
<b>Power</b>	150W
<b>Input wiring</b>	2000mm input cord with two-pole Europlug
<b>Output wiring</b>	500mm output cord with two-pole Europlug socket
<b>Sensor finish</b>	black

Recessed sensor

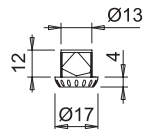
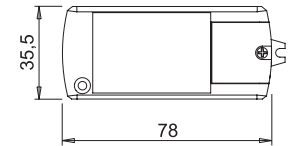
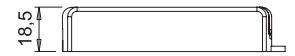

NOTE: Read the installation manual for more details on drilling for assembly.

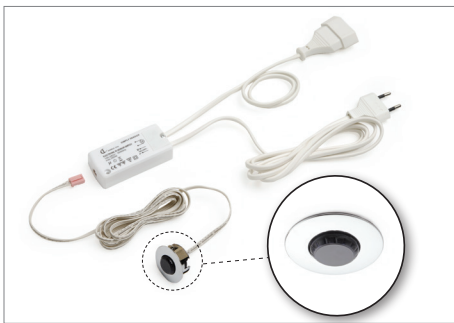

**SIMPLY R2**



Touchless switch

<b>Code</b>	0834909B - 0834917B - 0834928B	
<b>Input</b>	220-240Vac	
<b>Output</b>	220-240Vac	
<b>Power</b>	150W	
<b>Input wiring</b>	2000mm input cord with two-pole Europlug	
<b>Output wiring</b>	500mm output cord with two-pole Europlug socket	
<b>Sensor finish</b>	chrome plated	0834909B
	satin nickel	0834917B
	satin chrome	0834928B

Recessed sensor with metal holder

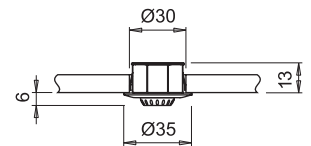
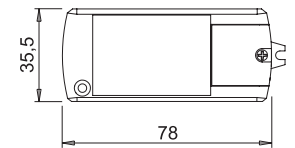

NOTE: Read the installation manual for more details on drilling for assembly.



chrome plated

satin nickel

satin chrome

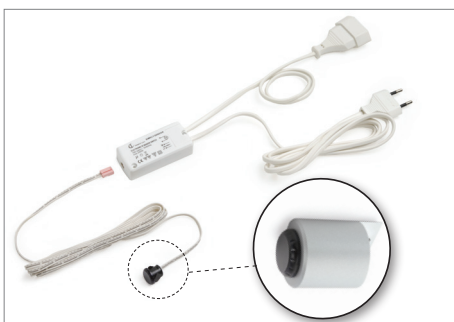

**SIMPLY SP1**



Touchless switch

<b>Code</b>	0834901B3 - 0834905B3	
<b>Input</b>	220-240Vac	
<b>Output</b>	220-240Vac	
<b>Power</b>	150W	
<b>Input wiring</b>	2000mm input cord with two-pole Europlug	
<b>Output wiring</b>	500mm output cord with two-pole Europlug socket	
<b>Sensor finish</b>	white	0834901B3
	aluminium	0834905B3

Surface sensor with metal holder

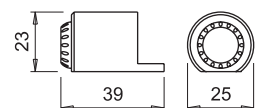
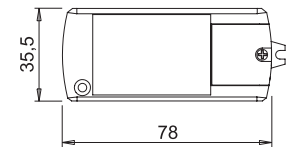
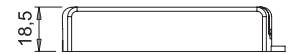

white

aluminium

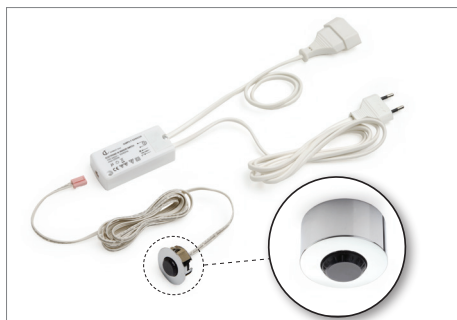

chrome plated



satin nickel



satin chrome

**SIMPLY SP2**

Touchless switch

<b>Code</b>	0834909B1 - 0834917B1 - 0834928B1	
<b>Input</b>	220-240Vac	
<b>Output</b>	220-240Vac	
<b>Power</b>	150W	
<b>Input wiring</b>	2000mm input cord with two-pole Europlug	
<b>Output wiring</b>	500mm output cord with two-pole Europlug socket	
<b>Sensor finish</b>	chrome plated	0834909B1
	satin nickel	0834917B1
	satin chrome	0834928B1

Surface sensor with metal holder

230V

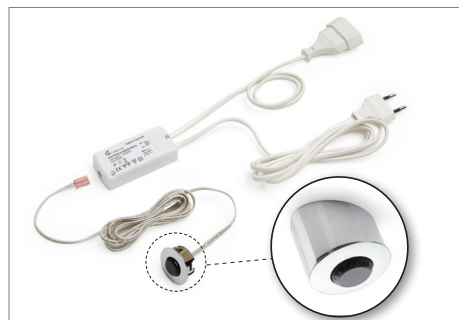
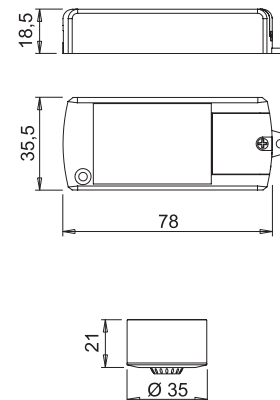

chrome plated



satin nickel



satin chrome

**SIMPLY OB**

Touchless switch

<b>Code</b>	0834909B2 - 0834917B2 - 0834928B2	
<b>Input</b>	220-240Vac	
<b>Output</b>	220-240Vac	
<b>Power</b>	150W	
<b>Input wiring</b>	2000mm input cord with two-pole Europlug	
<b>Output wiring</b>	500mm output cord with two-pole Europlug socket	
<b>Sensor finish</b>	chrome plated	0834909B2
	satin nickel	0834917B2
	satin chrome	0834928B2

Surface sensor with metal holder

230V

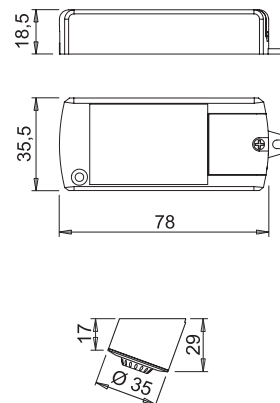
**How SIMPLY works**

All SIMPLY models are configured in on-off switch mode. Wave your hand in front of the sensor to turn the device on and off.



on-off function