

KINVARO

T-57 lift-up flap fitting



- Opening angle adjustable to 75° or 90°
- Easy to fit
- Adjustable spring force
- Adjustable flap height ± 1.0 mm
- No hinges fitted to the top panel
- Allows additional cabinet installation above
- Can be used for wooden flaps or aluminium frames with glass infill
- Weight 1.0 to 6.2 kg
- Range of flaps:
Width: up to 1200 mm
Height: 300 – 600 mm
- High-quality finish, nickel-plated

APPLICATION RANGE

Cabinet height	Flap weight incl. handle	
	min.	max.
300	1.0	6.2
350	1.2	4.9
400	1.4	3.8
450	1.5	3.6
500	1.7	2.9
550	1.9	2.7
600	2.1	2.5

ORDER INFORMATION

Kinvaro T-57 set			
Designation	Version for	Overlay	Art.-no.
Kinvaro T-57, nickel-plated adjustable springs on right and left	wood	variable	F151145224
	aluminium	14	F151145222
16		F151145223	

Kinvaro T-57 set comprises:

- 1** Fitting, right and left (1x)
- Paper template (1x)
- Installation instructions (1x)

Assembly aids	50
Kinvaro T-57 adjustment options	45

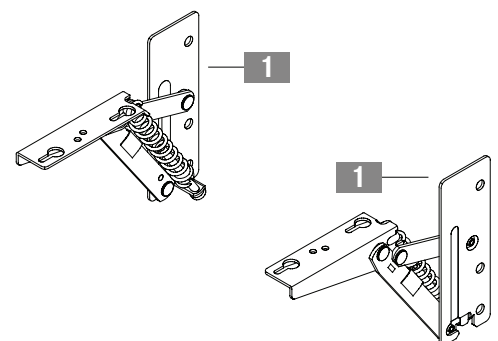

ASSEMBLY AND INSTALLATION INSTRUCTIONS

All dimensions in millimetres

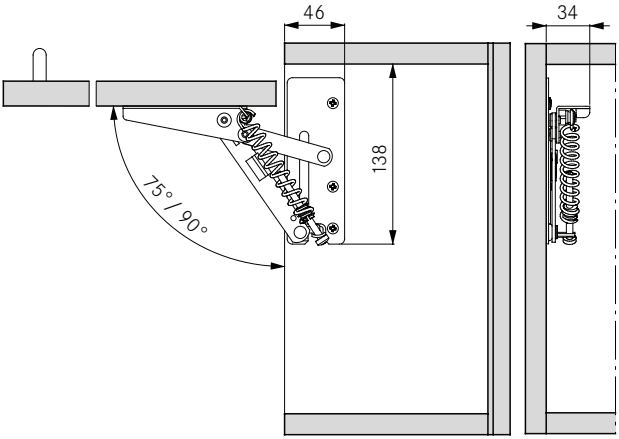
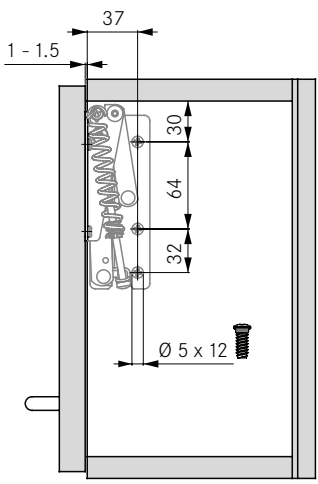
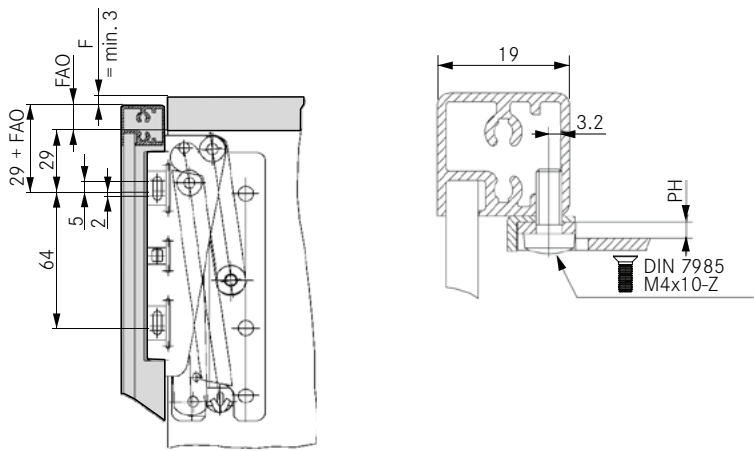
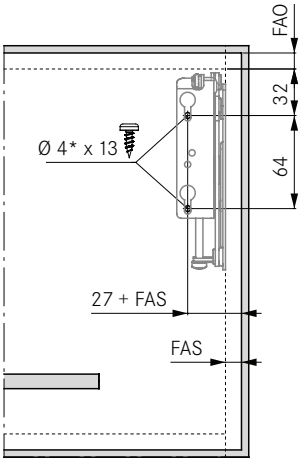
<p>Required space</p> 	<p>Side wall drilling positions</p> 
<p>Front: installation for flaps with standard aluminium frame profiles (19 mm)</p> 	<p>Front: installation for wooden and frame flaps (min. 55 mm width)</p>  <p>* Pre-drilling required - Ø 2 mm</p>
<p>Calculation of flap weight</p> <p>Flap width x flap height x flap thickness x density¹ + weight of handle² = weight of flap</p> <p>¹ Densities: MDF 0.85 kg/dm³, chipboard 0.65 kg/dm³, spruce/pine 0.45 kg/dm³</p> <p>² For bar handles allow 0.1 kg for each 100 mm handle width. We recommend a trial fitting</p>	

WARNING

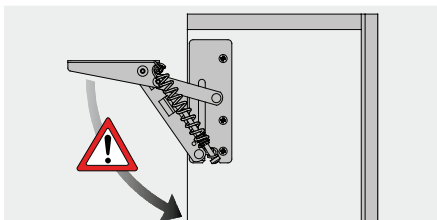

Important!
Caution - risk of injury!
Fitting is spring-tensioned!

LEGEND

- F Reveal
- FAO Front overlay, top
- FAS Front overlay, side
- PH Stamping height