

# T-type-i 110

For wood doors

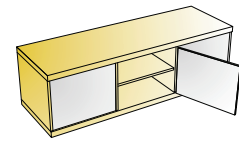
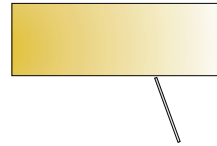
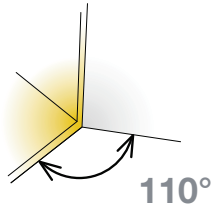

- Opening angle
- Drilling diameter for hinge cup
- Drilling depth
- Hinge on plate mounting system

110°  
35mm  
12mm  
3Way snap-on



Technical details

	Interaxis 45mm	Interaxis 48mm
Cup type		
Item number		

Cranking  
0mm

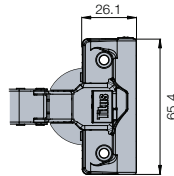
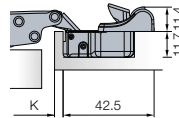
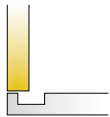

150 Pcs    Made of steel

	<b>701-0AT0-054</b>	701-0AS0-054
	701-0AT1-054	701-0AS1-054
	701-0AT4-054	701-0AS4-054

Drilling patterns for hinge cups → see page 2.17

Cranking  
5mm

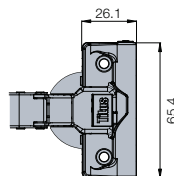
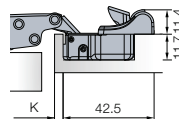
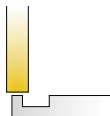

150 Pcs    Made of steel

	701-0BT0-054	701-0BS0-054
	701-0BT1-054	701-0BS1-054
	701-0BT4-054	701-0BS4-054

Drilling patterns for hinge cups → see page 2.17

## Mounting plates



Cam adjustable cruciform mounting plate  
→ see page 2.81



Cruciform mounting plate  
→ see page 2.83



Cam adjustable linear mounting plate  
→ see page 2.81



Face frame adapter plate  
→ see page 2.83

## Hinge cup screws

If not pre-mounted

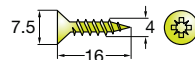

**820-6328-050**

10000 Pcs



Accessories

Cover caps for hinge arm  
→ see page 2.177



Hinge angle restrictor  
→ see page 2.175

## Legend of hinge cup symbols

Screw-on ready  
← screws

Machine insertion ready

EasyFix system

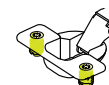

Damping adjustment

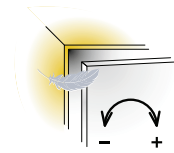

Door adjustment

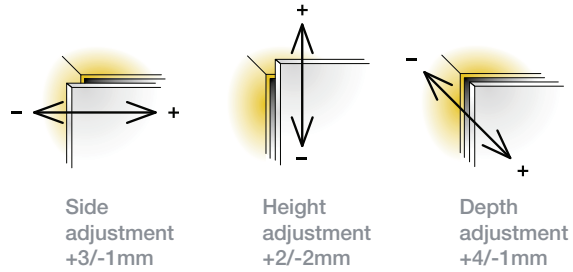

Side adjustment  
+3/-1mm

Height adjustment  
+2/-2mm

Depth adjustment  
+4/-1mm

For further explanation → see page 2.25

For further explanation → see pages 2.22-2.24

Mounting details

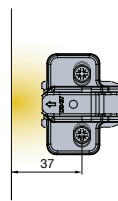
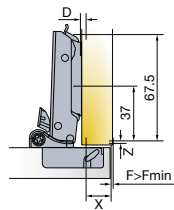
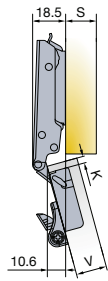

Drawings show application on D=0mm mounting plate

Mounting plate drilling distance

Mounting plate thickness table

For further explanation → see page 2.13

X 13 14 15 16 17 18 19

	3	3	2	1	0		
	4	4	3	2	1	0	
K	5		4	3	2	1	0
	6			4	3	2	1 0 D

$D=13+K-X$

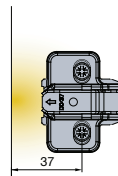
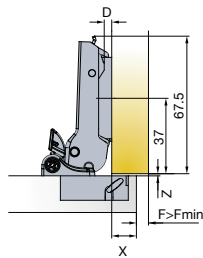
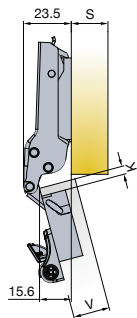

Drawings show application on D=0mm mounting plate

X 8 9 10 11 12 13 14

	3	3	2	1	0		
	4	4	3	2	1	0	
K	5		4	3	2	1	0
	6			4	3	2	1 0 D

$D=8+K-X$

Touch opening



PushOpen Solutions  
→ see pages 2.199-2.204

Door clearance at R=1mm

For further explanation → see page 2.14

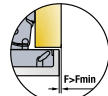

V 16 17 18 19 20 21 22 23 24 25 26

	3	0.5	0.7	0.8	1	1.2	1.5	1.7	2.1	2.8	4.1	5.5
	4	0.4	0.7	0.8	1	1.2	1.5	1.7	2.1	2.3	3.1	4.5
K	5	0.4	0.6	0.7	0.9	1.1	1.4	1.6	2	2.2	2.6	3.5
	6	0.4	0.6	0.7	0.9	1.1	1.4	1.6	2	2.2	2.6	2.9 F <sub>MIN</sub>

Gap Z<sub>MIN</sub>=0