

T-type-i 110

For wood doors

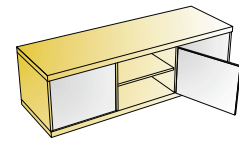

- Opening angle 110°
- Drilling diameter for hinge cup 35mm
- Drilling depth 12mm
- Hinge on plate mounting system 3Way snap-on

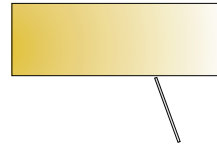
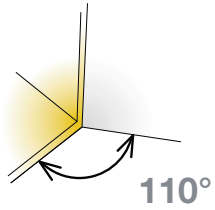

Technical details

Cup type	Interaxis 45mm	Interaxis 48mm
Item number		

Cranking
9mm

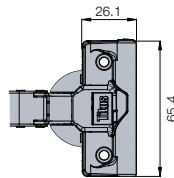
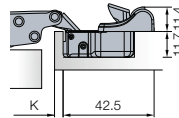
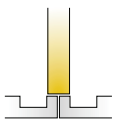

150 Pcs

Made of steel

	701-OCT0-054	701-OCS0-054
	701-OCT1-054	701-OCS1-054
	701-OCT4-054	701-OCS4-054

Drilling patterns for hinge cups → see page 2.17

Cranking
17mm

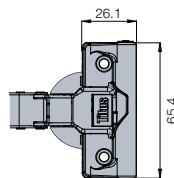
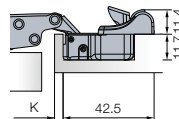
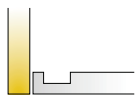

150 Pcs

Made of steel

	701-ODT0-054	701-ODS0-054
	701-ODT1-054	701-ODS1-054
	701-ODT4-054	701-ODS4-054

Drilling patterns for hinge cups → see page 2.17

Mounting plates



Cam adjustable cruciform mounting plate
→ see page 2.81



Cruciform mounting plate
→ see page 2.83



Cam adjustable linear mounting plate
→ see page 2.81



Face frame adapter plate
→ see page 2.83

Hinge cup screws

If not pre-mounted

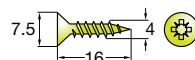

820-6328-050

10000 Pcs

Accessories



Cover caps for hinge arm
→ see page 2.177

Hinge angle restrictor
→ see page 2.175

Legend of hinge cup symbols

Screw-on ready
← screws

Machine insertion ready

EasyFix system

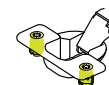

Damping adjustment

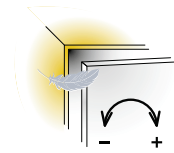

Door adjustment

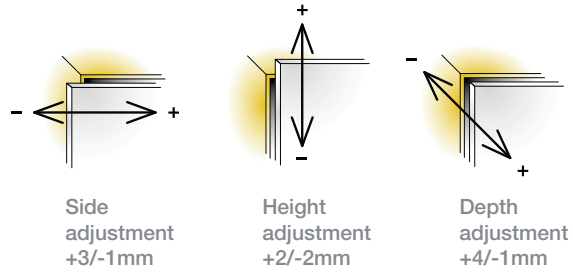

Side adjustment
+3/-1mm

Height adjustment
+2/-2mm

Depth adjustment
+4/-1mm

For further explanation → see page 2.25

For further explanation → see pages 2.22-2.24

Mounting details

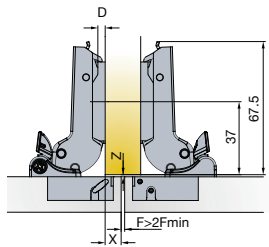
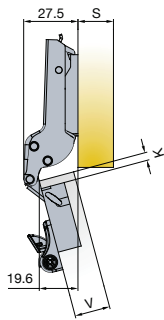

Mounting plate drilling distance

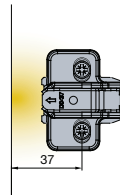

Mounting plate thickness table

For further explanation → see page 2.13

X	4	5	6	7	8	9	10
3	3	2	1	0			
4	4	3	2	1	0		
K							
5		4	3	2	1	0	
6			4	3	2	1	0

$D = 4 + K - X$

Drawings show application on D=0mm mounting plate

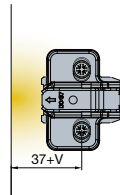
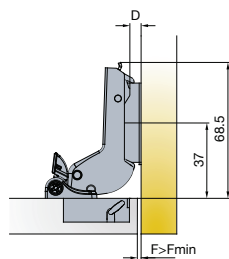
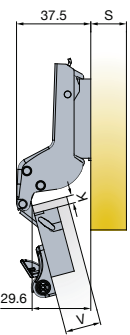

V	16	17	18	19	20	21	22	23	24
3	0	0	0	0	1	1	1	1	2
4	1	1	1	1	2	2	2	2	3
K									
5	2	2	2	2	3	3	3	3	4
6	3	3	3	3	4	4	4	4	

$D = -4 + K + F$

Drawings show application on D=2mm mounting plate

Touch opening



PushOpen Solutions
→ see pages 2.199-2.204

Door clearance at R=1mm

For further explanation → see page 2.14

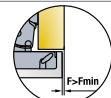

V	16	17	18	19	20	21	22	23	24	25	26
3	0.5	0.7	0.8	1	1.2	1.5	1.7	2.1	2.8	4.1	5.5
4	0.4	0.7	0.8	1	1.2	1.5	1.7	2.1	2.3	3.1	4.5
K											
5	0.4	0.6	0.7	0.9	1.1	1.4	1.6	2	2.2	2.6	3.5
6	0.4	0.6	0.7	0.9	1.1	1.4	1.6	2	2.2	2.6	2.9

Gap $Z_{MIN} = 0$