

# T-type Mounting Plates

3Way snap-on mounting

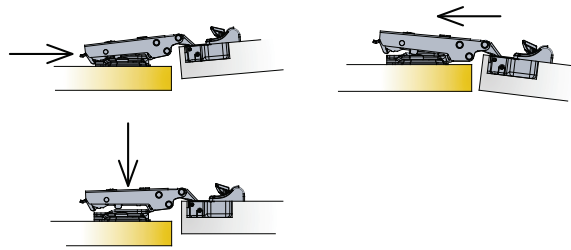

Cruciform mounting plate 37mm

Drilling pattern

Dimensions

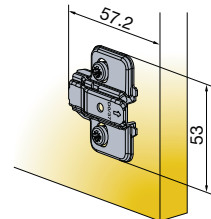
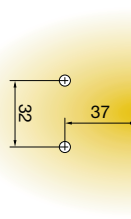

150 Pcs Made of steel

Cam adjustable  
face frame mounting plate

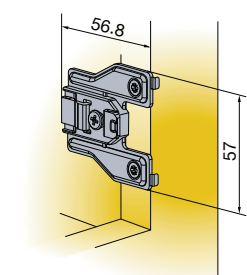
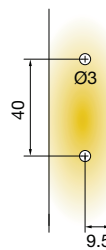

150 Pcs Made of steel and zinc

Fixing screw for cruciform mounting plate  
*If not pre-mounted*

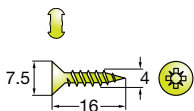

Chipboard screws  
820-6328-050

10000 Pcs

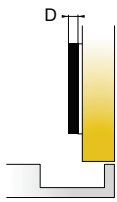

Mounting plate thickness

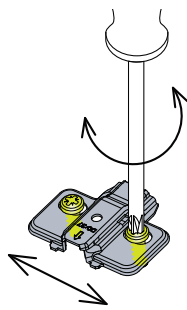



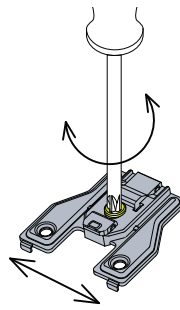



Height adjustment +2/-2mm



Height adjustment +2/-2mm

Mounting plate type		 15		 10.5	 14.5		
Mounting plate thickness (D)							
Item number							
0mm	700-0NA0-054	700-0NC0-054	700-0NB0-054	700-0NF0-054	700-0NE0-054		
1mm	700-0NA1-054	700-0NC1-054	700-0NB1-054	700-0NF1-054	700-0NE1-054		
2mm	700-0NA2-054	700-0NC2-054	700-0NB2-054	700-0NF2-054	700-0NE2-054		
3mm	700-0NA3-054	700-0NC3-054	700-0NB3-054	700-0NF3-054	700-0NE3-054		
4mm	700-0NA4-054	700-0NC4-054	700-0NB4-054	700-0NF4-054	700-0NE4-054		
0mm						700-0KW0-054	
3mm						700-0KW3-054	

Legend of mounting plate type symbols

	 15		 10.5	 15	 14.5
Screw-on ready for chipboard screws ← screws	Pre-mounted 15mm euro screws	Machine insertion ready	Pre-mounted 10.5mm expanding dowels	Pre-mounted chipboard screw	Pre-mounted chipboard screw
