

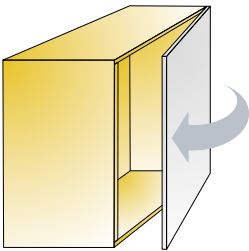

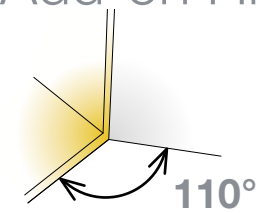



Glissando TT

Glissando TL3

Add-on Hinge Damper

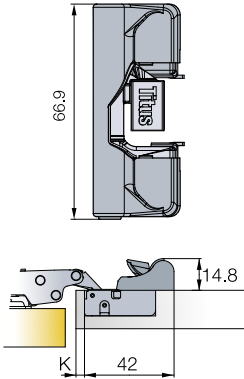
For 95°, 110° and 120° hinges

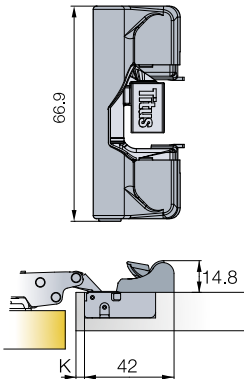

Technical details		Hinge opening angle	Item number
<div>Glissando TT</div> <ul style="list-style-type: none"> T-type 95 T-type 110 T-type 120  <div>  </div> <div> <div>  200 Pcs </div> <div>Made of steel and plastic</div> </div>		95°, 110°, 120°	729-0K71-054
		110°	951-0D45-054
<div>Glissando TL3</div> <ul style="list-style-type: none"> S-type 110 B-type 110  <div>  </div> <div> <div>  200 Pcs </div> <div>Made of steel and plastic</div> </div>			

- Same item can be used on most of crankings and angled hinges
- Intuitive snap-on mounting
- Low protrusion in cabinet interior
- Consistent performance across a broad range of furniture doors

Mounting details

Tool-less mounting

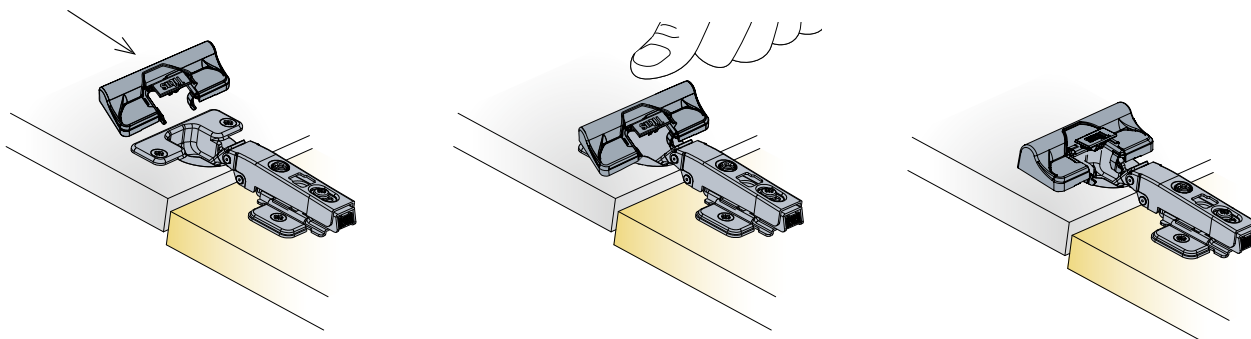

Insert Glissando TL into the holes on the hinge

Press down

Dismounting details

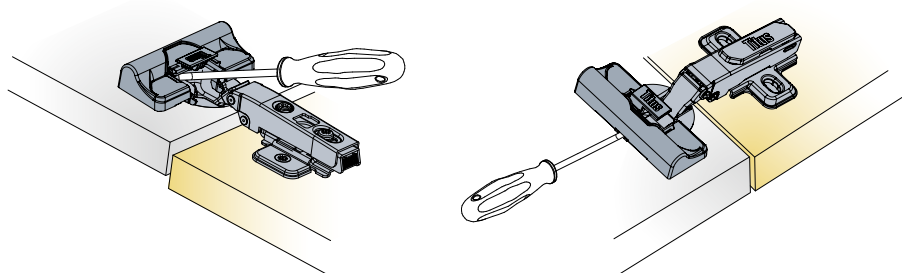

Use flat screwdriver

A trial mounting is always recommended.

Recommended number of Glissandos per door

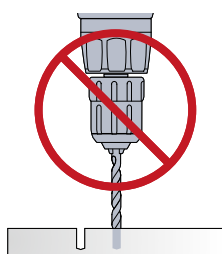

No additional drilling is required

