

T-type 110 Unsprung Hinge

For wood doors

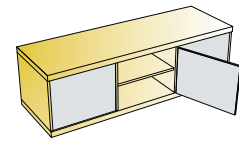
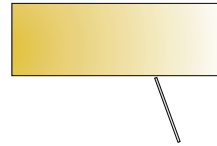
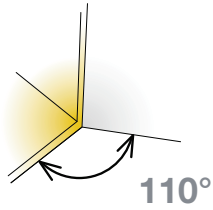

- Opening angle
- Drilling diameter for hinge cup
- Drilling depth
- Hinge on plate mounting system

110°
35mm
12mm
3Way snap-on



Technical details

	Interaxis 45mm	Interaxis 48mm
Cup type		
Item number		

Cranking

0mm

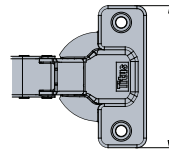
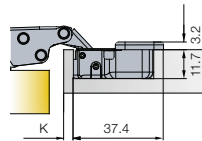
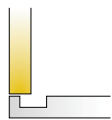

	704-0593-054	704-0672-054
		704-0553-054

Drilling patterns for hinge cups → see page 2.17

150 Pcs

Made of steel

Cranking

5mm

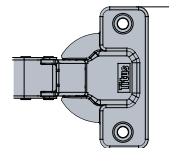
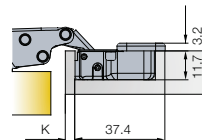
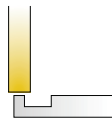

	704-0661-054	704-0673-054
		704-0604-054

Drilling patterns for hinge cups → see page 2.17

150 Pcs

Made of steel

Mounting plates



Cam adjustable cruciform mounting plate
→ see page 2.81



Cruciform mounting plate
→ see page 2.83



Cam adjustable linear mounting plate
→ see page 2.81



Face frame adapter plate
→ see page 2.83

Hinge cup screws
If not pre-mounted



820-6328-050

10000 Pcs

Accessories



Cover caps for hinge arm
→ see pages 2.177



Hinge angle restrictor
→ see page 2.175

Legend of hinge cup symbols

Screw-on ready
← screws

EasyFix system

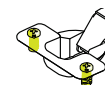

· Concealed hinge without spring for use with PushOpen mechanisms with magnet

→ see pages 2.199-2.204

Door adjustment

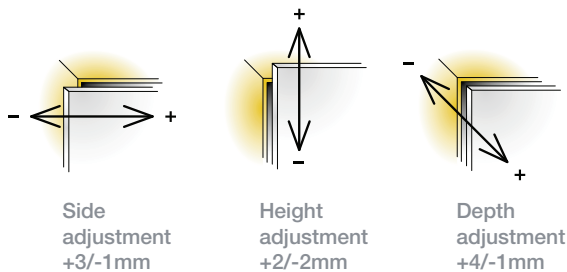

For further explanation → see pages 2.22-2.24

Mounting details

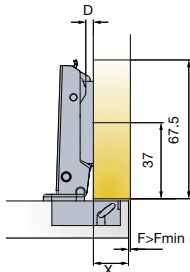
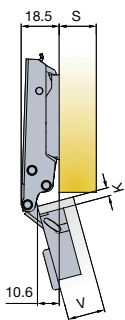

Mounting plate drilling distance

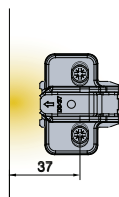

Mounting plate thickness table

For further explanation → see page 2.13

X	13	14	15	16	17	18	19
3	3	2	1	0			
4	4	3	2	1	0		
K							
5		4	3	2	1	0	
6			4	3	2	1	0

$D=13+K-X$

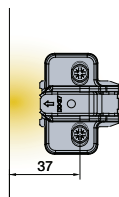
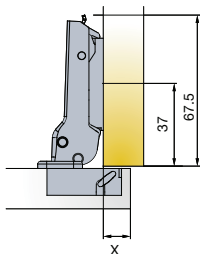
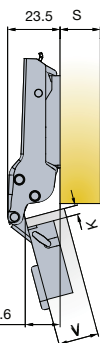

X	8	9	10	11	12	13	14
3	3	2	1	0			
4	4	3	2	1	0		
K							
5		4	3	2	1	0	
6			4	3	2	1	0

$D=8+K-X$

Touch opening



PushOpen Solutions
→ see pages 2.199-2.204

Door clearance at R=1mm

For further explanation → see page 2.14



V	16	17	18	19	20	21	22	23	24	25	26
3	0.5	0.7	0.8	1	1.2	1.5	1.7	2.1	2.8	4.1	5.5
4	0.4	0.7	0.8	1	1.2	1.5	1.7	2.1	2.3	3.1	4.5
K											
5	0.4	0.6	0.7	0.9	1.1	1.4	1.6	2	2.2	2.6	3.5
6	0.4	0.6	0.7	0.9	1.1	1.4	1.6	2	2.2	2.6	2.9

Gap $Z_{MIN}=0$